

ELABORATO PLANIMETRICO FG. 9 N. 244
 P.T.A 4001692
 Rapp. 4:200

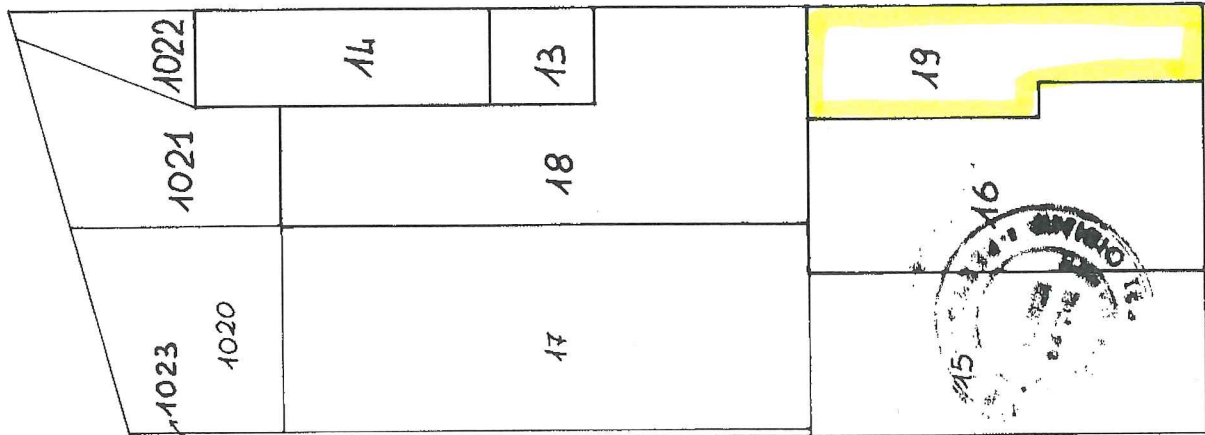

PIANO TERZO

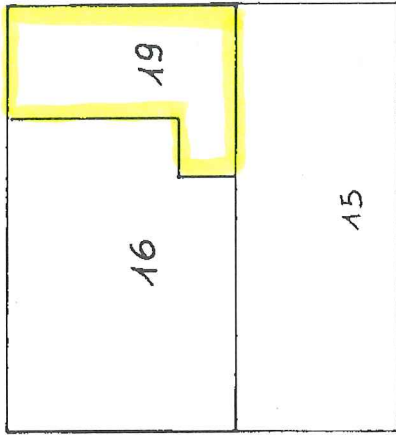

PIANO SECONDO

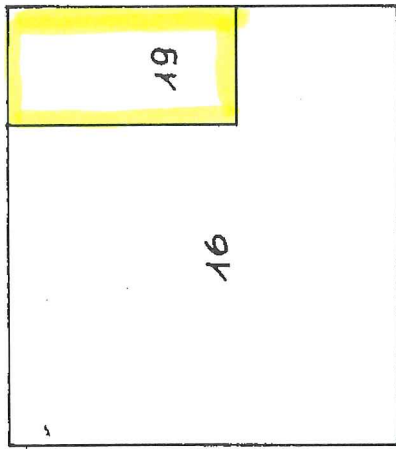

Gradienza Area terra

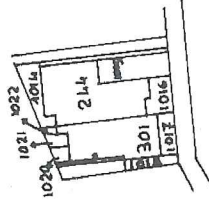

PLANIMETRIA: 4:2000

UNITÀ IMMOBILIARE SOPPRESSA

FG	N.	Sub
9	244	12

UNITA IMMOBILIARI INVARIATE
 FG. 9 N.244 Sub. 13-14-16

UTILITÀ COMUNI
 FG 9 N.244 sub. 19

UNITA' IMMOBILIARI DERIVATE		
FG	N	Sub
9	244	18
9	1021	
9	1022	
		Sup. mq.
		28
		9

Magazzino al piano terra
 Area urbana
 Area urbana

ALTRA PROPRIETÀ		
FG	N	Sub
9	244	15
9	244	17
9	1020	

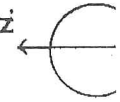

Ultima planimetria in atti